

00C/FBVR2R6F/300

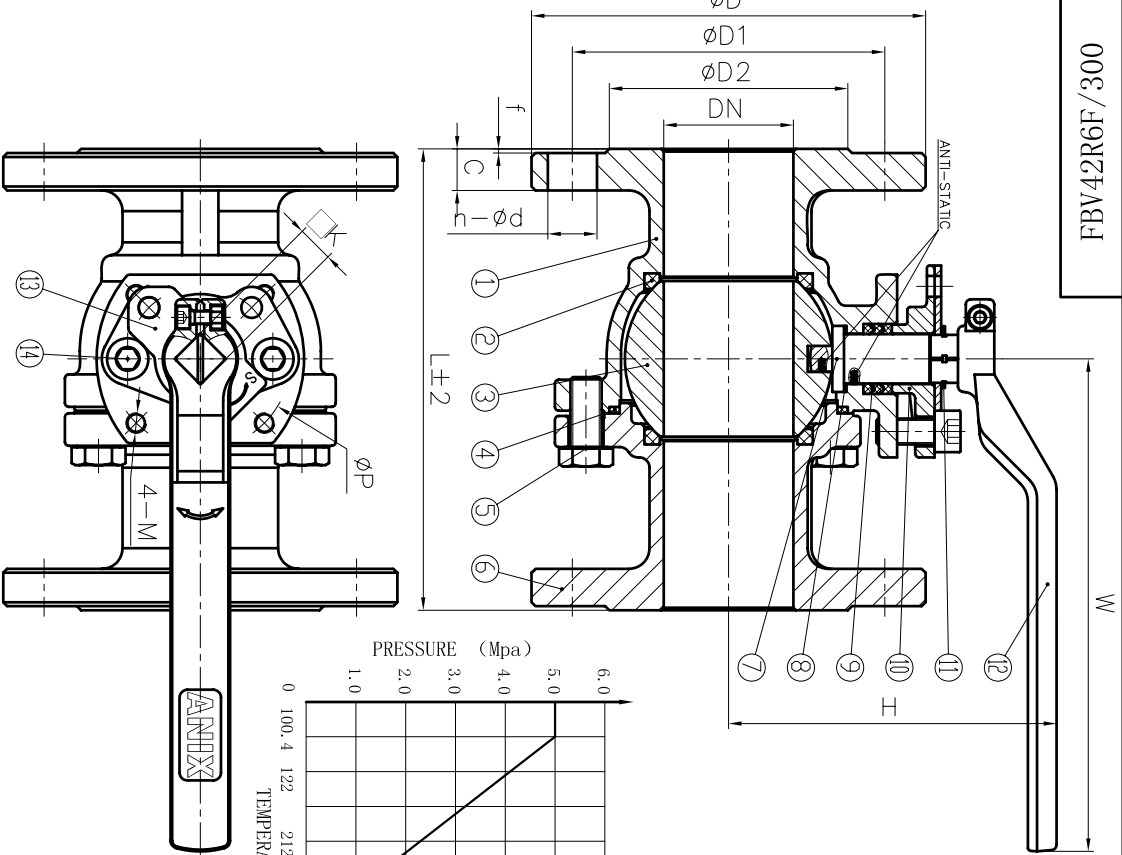

NPS	L	D	D1	D2	C	F	n-Ød	W	H	K	P	M	Weight (lb)
1/2"	5.512	3.740	2.626	1.374	0.591	0.063	4-Ø0.63	5.118	3.268	0.354	1.654	MO.197	4.409
3/4"	5.984	4.528	3.252	1.689	0.630	0.063	4-Ø0.748	5.118	3.504	0.354	1.654	MO.197	7.165
1"	6.496	4.921	3.500	2.000	0.709	0.063	4-Ø0.748	6.299	3.661	0.433	1.969	MO.236	8.818
1 1/4"	7.008	5.315	3.874	2.500	0.748	0.063	4-Ø0.748	6.299	3.819	0.433	1.969	MO.236	13.228
1 1/2"	7.480	6.102	4.500	2.874	0.827	0.063	4-Ø0.866	7.874	4.685	0.551	2.756	MO.315	17.637
2"	8.504	6.496	5.000	3.626	0.906	0.063	8-Ø0.748	7.874	5.000	0.551	2.756	MO.315	24.251
2 1/2"	9.488	7.480	5.874	4.126	1.024	0.063	8-Ø0.866	9.449	5.433	0.551	2.756	MO.315	33.069
3"	11.102	8.268	6.626	5.000	1.142	0.063	8-Ø0.866	10.630	6.614	0.669	4.016	MO.394	47.399
4"	12.008	10.039	7.874	6.189	1.260	0.063	8-Ø0.866	12.598	7.480	0.669	4.016	MO.394	74.957

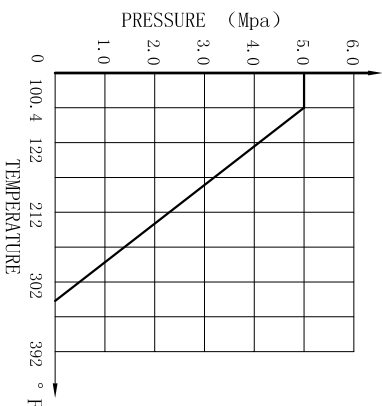

Nominal pressure		300LB	
Test pressure	Shell test	7.5	
	seal test	5.5	
	Gas seal test	0.6	
Applicable medium	water		
	air		
Applicable temperature	water, oil, gas		
			-20~356°F

NO.	DESCRIPTION	QTY	MATERIAL
1	HEXAGON HEAD BOLT	2	A193 B8M
13	STOPPER	1	SS304
12	HANDLE	1	STAINLESS STEEL
11	SNAP RING	1	SS304
10	GLAND	1	A351 CF8
9	PACKING	-	RPTFE
8	STEM WASHER	1	RPTFE
7	STEM	1	A276 316
6	BONNET	1	A351 CF8M
5	BOLT	-	A193 B8M
4	GASKET	1	RPTFE
3	BALL	1	SS316
2	SEAT	2	RPTFE
1	BODY	1	A351 CF8M

MARK	BEFORE MODIFIED	AFTER MODIFIED	DATE
DRG.		APP.	
CHK.		DATE	

ANIX®		SCALE
ANIX VALVE CO., LTD		
Flange Ball Valve		
300LB, CF8M, Fire Safe		
FBV42R6F/300		

NOTE:
 1. Design and Manufacture for valve according to ANSI B16.34-2009.
 2. Face-to-face dimensions for valve according to ASME B16.10-2009.
 3. End flange dimensions for valve according to ASME B16.5-2009.
 4. Inspection and Test for valve according to API 598-2009.

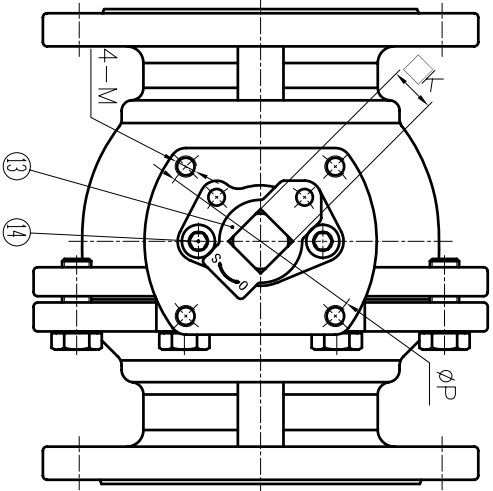
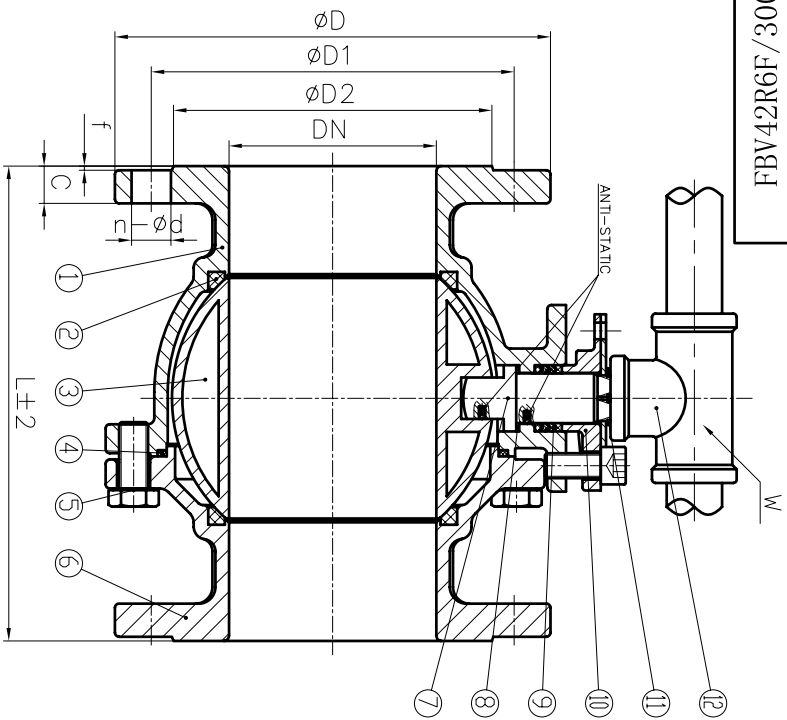

NOTE:

1. Design and Manufacture for valve according to ANSI B16.34-2009.
2. Face-to-face dimensions for valve according to ASME B16.10-2009.
3. End flange dimensions for valve according to ASME B16.5-2009.
4. Inspection and Test for valve according to API 598-2009.

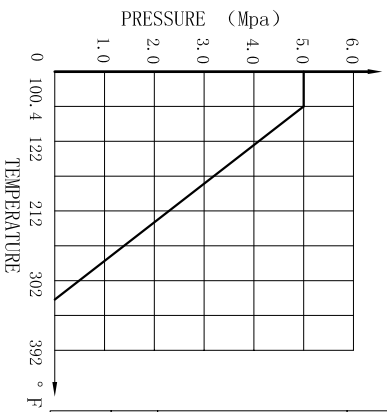

Nominal pressure		300LB			
Shell test	7.5	test medium	water	Test temperature	normal temperature
Test pressure	5.5				
Gas seal test	0.6	air			
Applicable medium		water, oil, gas			
Applicable temperature		-20~356°F			

NPS	L	D	D1	D2	C	f	n-Ød	W	K	P	M	Weight (lb)
5"	15.000	11.024	9.252	7.311	1.378	0.063	8-Ø0.866	21.654	0.827	4.016	M0.394	-
6"	15.866	12.598	10.626	8.500	1.457	0.063	12-Ø0.866	25.591	0.827	4.921	M0.472	-
8"	19.764	14.961	13.000	10.626	1.654	0.063	12-Ø0.984	31.496	1.063	5.512	M0.630	-
14	HEXAGON HEAD BOLT		2		A193 B8M							
13	STOPPER		1		SS304							
12	HANDLE		1		STAINLESS STEEL							
11	SNAP RING		1		SS304							
10	GLAND		1		A351 CF8							
9	PACKING		-		RPTFE							
8	STEM WASHER		1		RPTFE							
7	STEM		1		A276 316							
6	BONNET		1		A351 CF8M							
5	BOLT		-		A193 B8M							
4	GASKET		1		RPTFE							
3	BALL		1		SS316							
2	SEAT		2		RPTFE							
1	BODY		1		A351 CF8M							
NO.	DESCRIPTION		Q' TY		MATERIAL							
					ANIX VALVE CO., LTD							
					Flange Ball Valve							
					300LB, CF8M, Fire Safe							
					FBV42R6F/300							
MARK	BEFORE MODIFIED	AFTER MODIFIED	DATE		SCALE							
DRW.		APP.										
CHK.		DATE										

ANIX®